

MR Omni Bob Transom Door Latch

Features

- Easily-adjustable springbolts for left- or right-swing are included for fast conversion
- Nylon bumpers reduce vibration and prevent door rattle
- Optional doorkeeper holds door in open position

Material

- Lock engine: Aluminum
- Handles, escutcheons finish: Chrome, aluminum and black
- Privacy: Acetal



Omni Bob

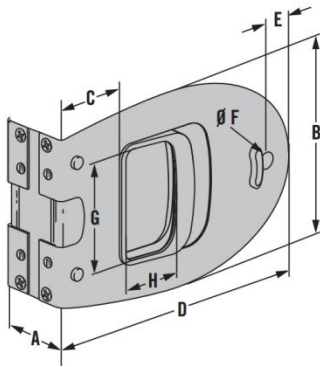

| | Imperial | | Metric |
|---|-----------------|---------|--------|
| | Nominal | Decimal | |
| A | Panel Thickness | | |
| B | 3 15/16 | 3.90 | 99 |
| C | 1 3/8 | 1.38 | 35 |
| D | 5 5/16 | 5.32 | 135 |
| E | 15/64 | .24 | 6 |
| F | 15/64 | .24 | 6 |
| G | 2 5/32 | 2.17 | 55 |
| H | 1 3/16 | 1.18 | 30 |

Panel Preparations

Omni Bob

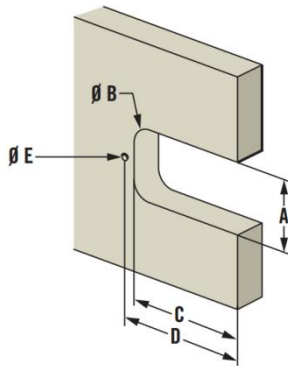

| | Imperial | | Metric |
|---|----------|---------|--------|
| | Nominal | Decimal | |
| A | 2 11/16 | 2.67 | 68 |
| B | 5/8 | .63 | 16 |
| C | 4 11/16 | 4.69 | 119 |
| D | 5 3/64 | 5.04 | 128 |
| E | 15/64 | .24 | 6 |

Omni Bob Single

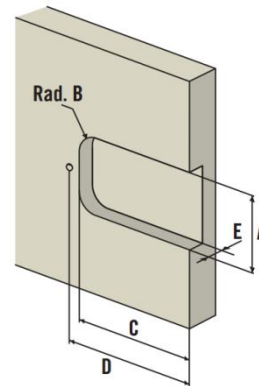

| | Imperial | | Metric |
|---|----------|---------|--------|
| | Nominal | Decimal | |
| A | 2 11/16 | 2.67 | 68 |
| B | 5/16 | .32 | 8 |
| C | 4 11/16 | 4.69 | 119 |
| D | 5 3/64 | 5.04 | 128 |
| E | 25/32 | .787 | 20 |

Omni Bob Part Numbers

| Door thickness range | Part Number |
|--------------------------------|---------------|
| 25 - 31 mm (1 - 1-1/4") | MR-04-106-24 |
| 30 - 36 mm (1-3/16 - 1-7/16") | MR-04-107-24 |
| 35 - 41 mm (1-3/8 - 1-5/8") | MR-04-108-24 |
| 40 - 46 mm (1-9/16 - 1-13/16") | MR-04-109-24 |
| 45 - 51 mm (1-3/4 - 2") | MR-04-1010-24 |

Omni Bob Single Part Numbers

| Door thickness range | Door Swing | Part Number |
|----------------------|-------------------|--------------|
| 25 mm (1") | right out/left in | MR-05-603-24 |
| 25 mm (1") | left out/right in | MR-05-703-24 |

MC Striker

Features

- Available in seven different sizes
- Suitable for Offshore, McCoy, Compact, and Omni swing door latches and many door and frame configurations and door thicknesses
- Striker tongue prevents wear from boat vibration
- Optional dustbin hides sawdust in the cut out hole and provides an elegant finish to the frame edge

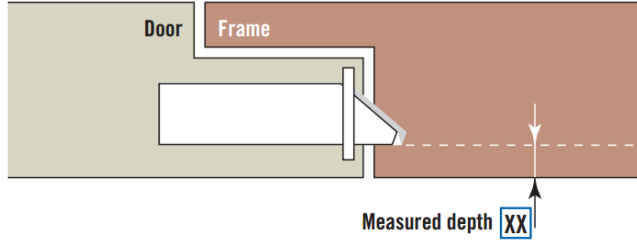
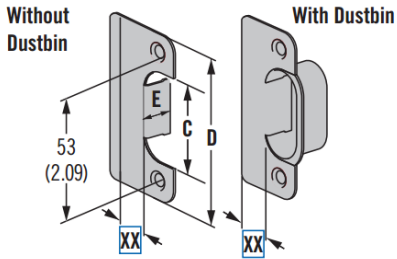

To find the right striker for your application, measure the distance from the door face to the edge of the springbolt of the latch.

| C | | D | | E | |
|--------|----------|--------|----------|--------|----------|
| Metric | Imperial | Metric | Imperial | Metric | Imperial |
| 36 | 1 7/16 | 68 | 2 11/16 | 13 | 1/2 |

MC - 90 - Z XX - FF

Z Dustbin Option
 1 No Dustbin
 2 With Dustbin

XX Position
 03 3mm (7/64")
 05 5mm (3/16")
 07 7mm (1/4")
 09 9mm (3/8")
 13 13mm (1/2")
 16 16mm (5/8")
 21 21mm (7/8")

FF Finish
 10 Brass, nickel plated
 24 Stainless steel
 40 Brass

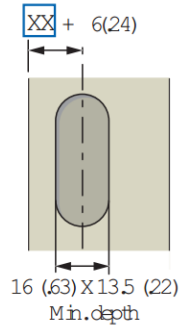

MC Whale Striker

Features

- Suitable for Offshore, McCoy and Compact swing door latches
- Quick and easy installation

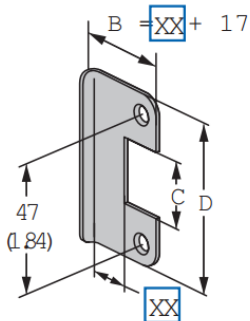

MC - 90 - 3 - XX - FF

XX Position
 03 3mm (7/64")
 05 5mm (3/16")
 07 7mm (1/4")
 09 9mm (3/8")
 13 13mm (1/2")
 16 16mm (5/8")
 21 21mm (7/8")

FF Finish
 10 Brass, nickel plated
 40 Brass



| C | | D | |
|--------|----------|--------|----------|
| Metric | Imperial | Metric | Imperial |
| 60 | 2 3/8 | 22 | 7/8 |